



# USER MANUAL

*He makes his home where the living is best.*  
— *Latin Proverb*

# SMART SHADES INSTALLATION

Before installing and using this product, please read the installation guide carefully.

## **!!! IMPORTANT !!!**

Please charge the battery using the USB cable provided in the pack and a regular phone charger. We ship out the devices with up to **15%** charge due to **IATA** policy regarding lithium batteries.

1



Download the app by scanning the QR code from the package. Alternatively, search for "Smart Shades" in Google Play or Apple App Store. Install the mobile app.

2



On your phone settings make sure to turn on Bluetooth connection and open the Smart Shades app.

3



Hold your hand on the front panel for few seconds to activate Smart Shades. The Device has a touch sensitive front panel.

4



Open the Smart Shades app and hold your smartphone next to an activated Smart Shades. Wait until your device discovers Smart Shades.

5



Follow the on-screen instructions  
and move your shades to their  
middle position.



6



Remove the front cover.

7



Use up or down arrows in the mobile app to feed the chain to the gear. After the chain is connected press stop. Use up and down arrows to distribute the chain equally to each side.

8



Use a cloth to clean the surface, make sure the surface is dry before installing the Smart Shades.

9



Attach the Smart Shades to the wall. Use the tape on the back of the device or screws (not included). Make sure that the chain is not crossed or too loose/tight.

See the following images.



Incorrect placement.



Correct placement.

10



Start the configuration process. Set the high and, the low point for the blind.

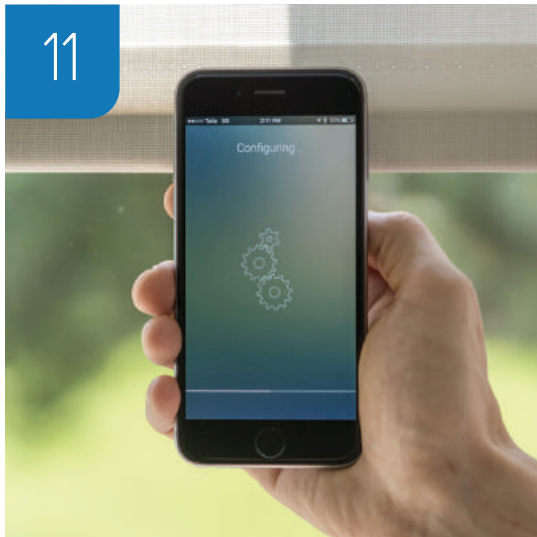

Follow the on-screen instructions and complete the set-up.



CONGRATULATIONS!  
INSTALLATION  
COMPLETE!  
WELCOME TO A  
SMARTER HOME.

# SOLAR PANEL INSTALLATION

## **Important:**

The solar panel must always be installed indoors, directly against the glass so as to allow as much natural light as possible to reach the panel.

Make sure that all the solar cells are exposed to daylight.

1

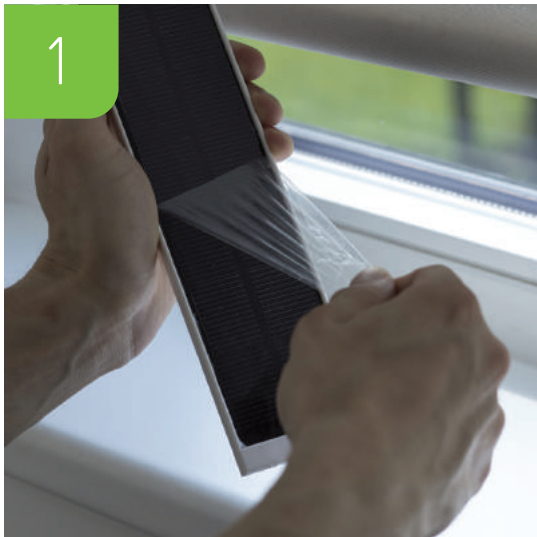

Remove the protective film from the solar panel. Also, remove the protective film from the adhesive strip on the front of the panel.

2



Position the bezel with solar panel facing outdoors, then press it firmly against the glass for 5 seconds.

3



Firmly insert the charging plug into the socket. When inserted correctly, the plug has to make a clicking sound when pushed into the socket.

SOLAR PANEL  
INSTALLATION  
COMPLETE!

# TROUBLESHOOTING

## 1 Device is not activating

- \* We ship out the devices with up to **15%** charge due to **IATA** policy regarding lithium batteries.
- \* Please charge the battery using the USB cable provided in the pack and a regular phone charger.
- \* Make sure the charging plug is completely pushed into the device.

- \* Try turning the Bluetooth off and on again
- \* Make sure that you are using the latest Smart Shades mobile app.

2

## How do I remove the chain from the device?

Carefully pry the gear wheel off using a flat-head screwdriver or another similar tool.





3

I have a cord with a chain connector and it's blocking the chain's movement through the Smart Shades.



Depending on the length and the type of the chain, it is possible to bypass the connector.

Please contact support at **support@somasmarthome.com** for further assistance

Alternatively, the chain can be replaced with an endless loop chain. We recommend a size #10 plastic chain.

# SAFETY

**To avoid damaging the product, read the instructions before using:**

- 1.** Never immerse the device or solar panel into any liquid.
- 2.** Never drill holes into the device.
- 3.** Do not drop the device or the solar panel.
- 4.** Never pierce the solar panel or its bezel frame.
- 5.** Never put anything onto the solar panel (risk of scratching or breakage), especially during installation.

6. Once installed, never subject the wire harness or other components to strain, pinching, or cutting caused by moving objects.
7. Do not eat the product or the solar panel.
8. THIS PRODUCT IS NOT A TOY. KEEP AWAY FROM CHILDREN. IT IS NOT SUITABLE FOR CHILDREN UNDER THE AGE OF 5, AS SMALL PARTS AND/OR BROKEN PARTS MAY PRESENT A CHOKING HAZARD. IF SWALLOWED, SEEK IMMEDIATE MEDICAL HELP

# TECHNICAL DATA

## **Power**

Rechargeable via solar panel or USB charger

## **Compatible devices**

Android 4.3 or newer and iPhone or iPad iOS8 or newer

## **Operation range**

Up to 40m

## **Technology**

Bluetooth Low energy

## **Battery**

Internal lithium battery, 1400mah

Hereby, WAZOMBI LABS OÜ declares that the radio equipment type SOMA SMART SHADES device is in compliance with Directive 2014/53/EU. The full text of the EU declaration of conformity is available at the following internet address:

**[www.somasmarthome.com/compliance](http://www.somasmarthome.com/compliance)**



# COMPATIBILITY

**The maximum dimensions of the supported curtains** is up to 2 meters (7 feet) in width and 2 meters (7 feet) in height.

## Supported chain types

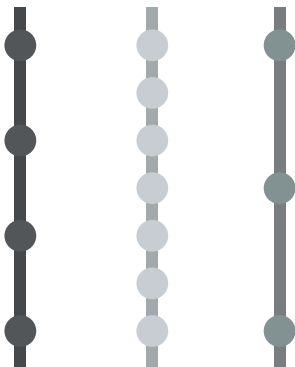

SOMA Smart Home warrants its motors, electrical and electronic accessories to be free from defects in material and workmanship under normal and proper use for a period of 1 year starting from the date of purchase.

EXCLUDED FROM WARRANTY: -If usage, adaptation or installation are not in accordance with our installation and operating instructions. -If the product has been opened, dismantled or returned with clear evidence of abuse or other damage. -If our written specifications are not properly applied by the Buyer when selecting the equipment. -If our written instructions for installation and wiring of the electrical connections have not been followed. -If our equipment has been used to perform functions other than the functions it was designed to handle, namely motorizing window and door enclosures e.g. shades, rolling shutters, awnings and projection screens which subject the SOMA Smart Home equipment to conditions which exceed its rated capacity. Please consult SOMA Smart Home about warranty for any uses other than that above.

SOMA Smart Home's only obligation shall be to repair or replace defective equipment which does not conform to the warranty. SOMA Smart Home shall not be liable for any injury, loss or damage, direct or consequential, arising out of, or the inability to use, the equipment. Before using, Buyer and/or the ultimate User shall determine the suitability of the product for its intended use, and User assumes all risks and liability in connection therewith.

# SUPPORT

For support please contact our team

[www.somasmarthome.com/pages/support](http://www.somasmarthome.com/pages/support)

or

[support@somasmarthome.com](mailto:support@somasmarthome.com)

Simple. Smart. Intelligent.

